

1 Verify Contents

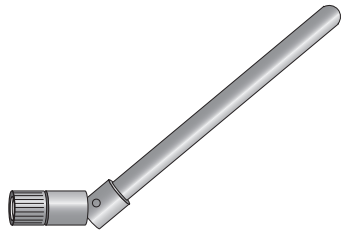

The information listed below is meant to help aid you in identifying the accessories included in your box. You may need to reference the product part number (X4-xxx-xxx-x) which is located on the Digi label on the outside of the box.



Cellular/ WiMAX Antenna

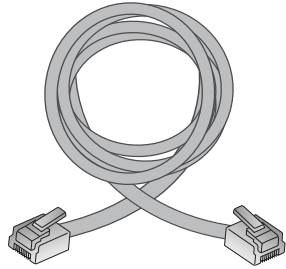

Ethernet Cable

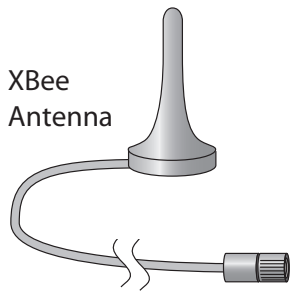

XBee Antenna

Part Number	# of Antennas
X4-xxx-Y-xxx-xx	2
All other models	1

Not included: If your device uses a SIM card, it must be supplied and activated by a cellular service provider for device operation.



Quick Start Guide

ConnectPort™ X4 H

90000978_D

2 Open Device

- a Unscrew and open the lid. Be sure to note that the top of the enclosure is hinged to the base on the power cord side.

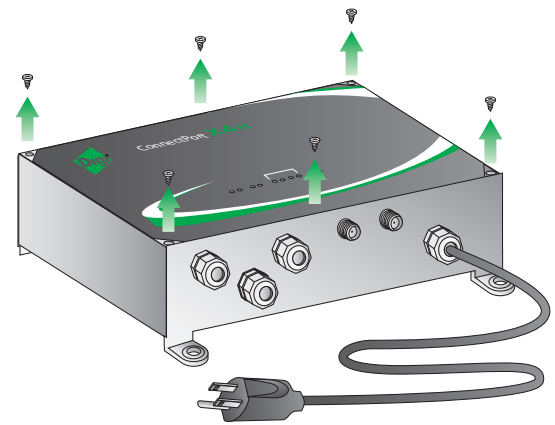

3 Install SIM/Ethernet

- a [GSM models only] Insert SIM card as shown.
NOTE: The primary SIM Card should be installed in the upper SIM slot, and the contacts should be face down. In the lower slot, the contacts should be face up. In both cases, the end of the SIM card with the chamfered corner should be inserted first.
- b Connect one end of the Ethernet cable to the ConnectPort X4 H and the other end to a PC.

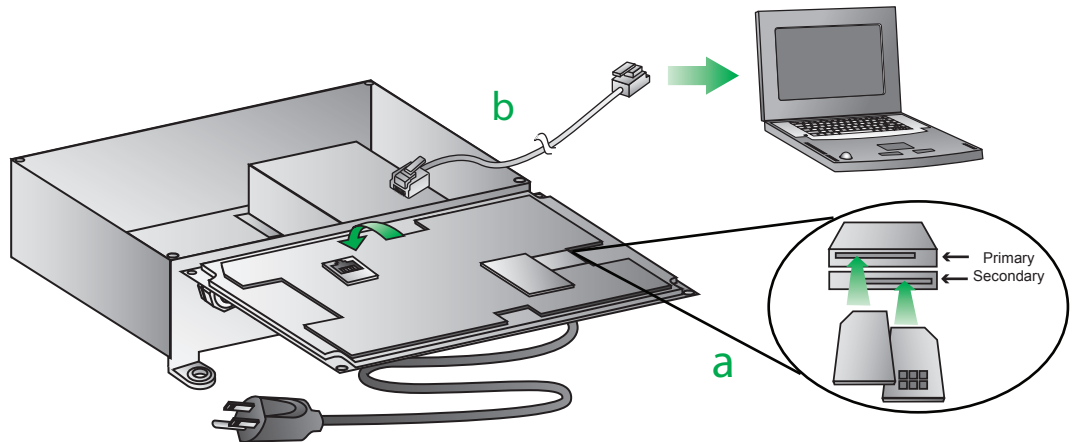

4 Connect Hardware

- a Connect the XBee antenna.
- b Connect the cellular antenna
NOTE: If you have a WiMAX model (X4-xxx-Yxxx-xx), connect the two WiMAX antennas to your unit instead of the cellular antenna depicted.
- c Power-up the unit by connecting the AC power cord to a proper power source.
NOTE: If you have a Class 1 Div 2 model that requires hard-wiring a power source to the unit, see the "ConnectPort™ X Family User's Guide" for wiring instructions, which can be found by clicking the link located in step D.
- d Once you have connected all the hardware, please refer to the ConnectPort X4 Getting Started Guide to configure the unit. This guide can be downloaded at www.digi.com/connectportx4. Once configured, refer to Step 5 to finalize the unit.

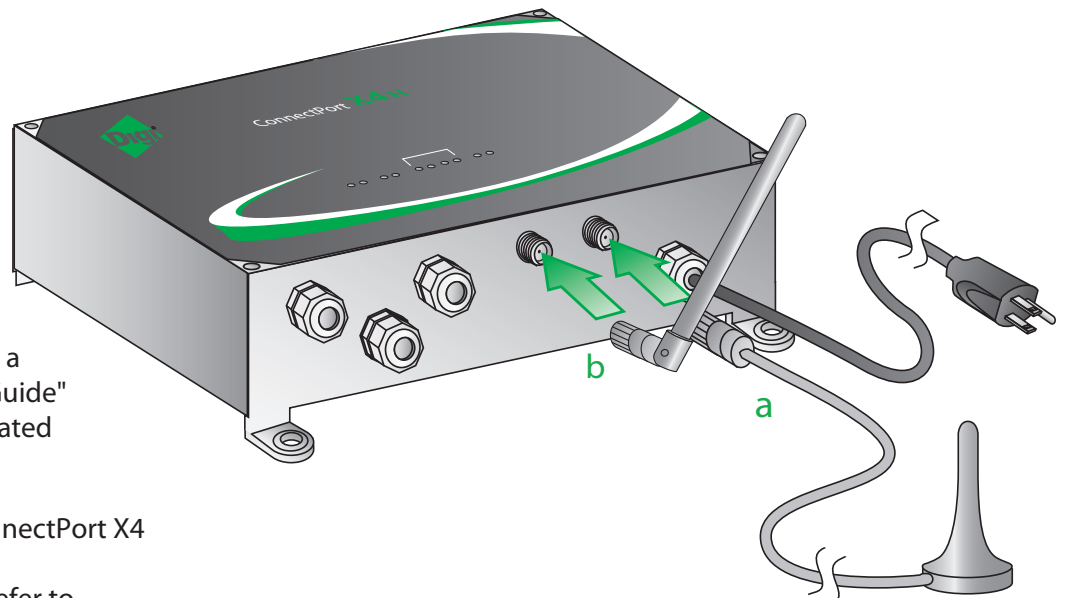



5 Finalize Unit

- a** Remove power from the unit by disconnecting it from the power source.
 - b** Remove the Ethernet cable and replace the screws that were removed in Step 2.
 - c** The unit now ready to use. Restore power to the unit by reconnecting it to the power source.
-